

POSSIBLE HORSE FRIENDLY VEHICLE BARRIER

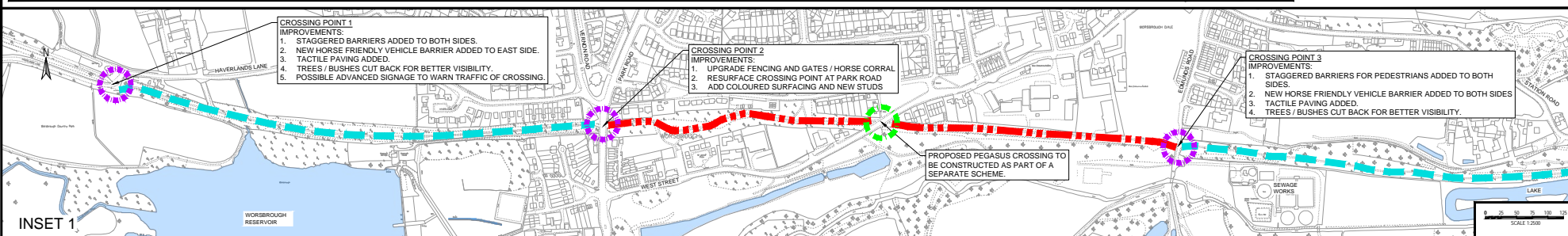

CROSSING POINT 1 IMPROVEMENTS:
 1. STAGGERED BARRIERS ADDED TO BOTH SIDES.
 2. NEW HORSE FRIENDLY VEHICLE BARRIER ADDED TO EAST SIDE.
 3. TACTILE PAVING ADDED.
 4. TREES / BUSHES CUT BACK FOR BETTER VISIBILITY.
 5. POSSIBLE ADVANCED SIGNAGE TO WARN TRAFFIC OF CROSSING.

CROSSING POINT 2 IMPROVEMENTS:
 1. UPGRADE FENCING AND GATES / HORSE CORRAL
 2. RESURFACE CROSSING POINT AT PARK ROAD
 3. ADD COLOURED SURFACING AND NEW STUDS

CROSSING POINT 3 IMPROVEMENTS:
 1. STAGGERED BARRIERS FOR PEDESTRIANS ADDED TO BOTH SIDES.
 2. NEW HORSE FRIENDLY VEHICLE BARRIER ADDED TO BOTH SIDES
 3. TACTILE PAVING ADDED.
 4. TREES / BUSHES CUT BACK FOR BETTER VISIBILITY.

PROPOSED PEGASUS CROSSING TO BE CONSTRUCTED AS PART OF A SEPARATE SCHEME.

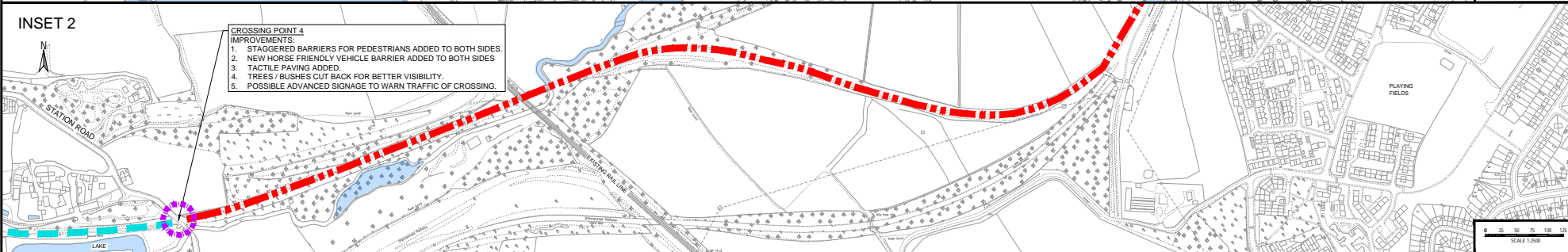

CROSSING POINT 4 IMPROVEMENTS:
 1. STAGGERED BARRIERS FOR PEDESTRIANS ADDED TO BOTH SIDES.
 2. NEW HORSE FRIENDLY VEHICLE BARRIER ADDED TO BOTH SIDES
 3. TACTILE PAVING ADDED.
 4. TREES / BUSHES CUT BACK FOR BETTER VISIBILITY.
 5. POSSIBLE ADVANCED SIGNAGE TO WARN TRAFFIC OF CROSSING.

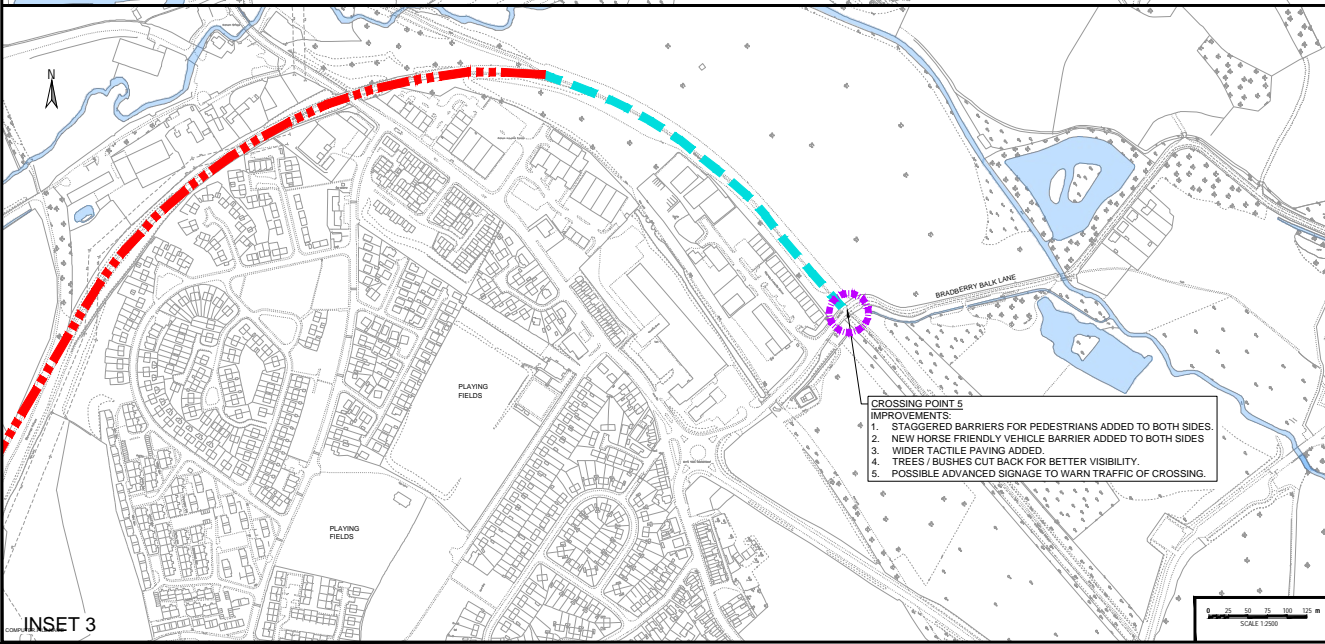

CROSSING POINT 5 IMPROVEMENTS:
 1. STAGGERED BARRIERS FOR PEDESTRIANS ADDED TO BOTH SIDES.
 2. NEW HORSE FRIENDLY VEHICLE BARRIER ADDED TO BOTH SIDES
 3. WIDER TACTILE PAVING ADDED.
 4. TREES / BUSHES CUT BACK FOR BETTER VISIBILITY.
 5. POSSIBLE ADVANCED SIGNAGE TO WARN TRAFFIC OF CROSSING.

KEY

- EXISTING TRANS PENNINE TRAIL ROUTE TO REMAIN UNALTERED OTHER THAN TRIMMING BACK OVER GROWN GRASS VERGE .
- EXISTING TRANS PENNINE TRAIL TO BE WIDENED ON THE SIDE OF THE NARROWER VERGE TO PROVIDE A SHARED CYCLE / FOOTWAY WIDTH OF 3m WHERE POSSIBLE. SECTIONS OF PATH PRONE TO FLOODING WILL BE LIFTED AND RE-SURFACED.

THE EXISTING WIDE VERGE WILL REMAIN FOR THE USE OF HORSES.

- LOCATION OF CROSSING POINT UPGRADE
- LOCATION OF CROSSING POINT UPGRADE TO BE CONSTRUCTED AS PART OF A SEPARATE SCHEME

This map is reproduced from Ordnance Survey material with the permission of Ordnance Survey on behalf of the Controller of Her Majesty's Stationary Office © Crown copyright. Unauthorised reproduction infringes Crown copyright and may lead to prosecution or civil proceedings. 10002284 (2009).

Rev.	By	Amendments	Date



Project: **WOMBWELL TO WORSBROUGH**

Drawing title: **CONSULTATION LAYOUT TPT UPGRADE**

Scale	Drawn	Checked	Date
AS SHOWN	ICG	GU	01.02.23

Drawing No.	Revision	File
HD/CONSULT/001		FILE

Paul Castle Service Director
 Growth & Sustainability Directorate
 Environment & Transportation (Business Unit 6)
 P.O. Box 601, Westgate Plaza One, Westgate
 Barnsley, S70 9FA
 Tel. (01226) 770770